



Model STW-V
1,5t/3,0t/5,0t



Model STW-V 10,0t

Steel jacks acc. to DIN 7355 with adjustable lifting claw model STW-V

Capacity 3000 - 10000 kg

The design of the steel jack allows for loads to be picked up and lowered from different heights over the entire length of the steel jack.

The adjustable claw is simply set to the appropriate application height in the load bar for this purpose.

Features

- The claw can be moved to any position on the adjusting rail.
- The load is supported either on the claw or the head of the steel jack.
- Robust base plate for a high level of stability.
- No reduction of capacity on the claw.

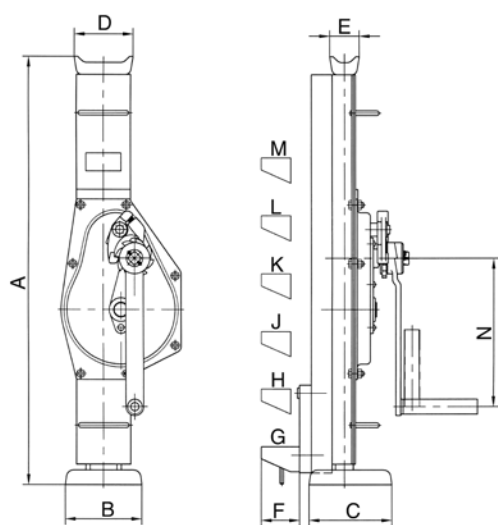

Dimensions model STW-V

Model	STW-V 15	STW-V 30	STW-V 50	STW-V 100
A, mm	725	725	725	800
B, mm	130	130	140	140
C, mm	140	140	160	160
D, mm	90	100	110	140
E, mm	50	50	68	76
F, mm	70	70	70	70
G, mm	80	80	80	85
H, mm	Claw freely adjustable on load bar (55 mm steps)			191
J, mm				297
K, mm				403
L, mm				509
M, mm				615
N, mm	250	250	250	300

Technical data model STW-V Siku

Model	EAN-No. 4025092* Siku	Capacity kg	Height A mm	Height of lift ¹ mm	Hand effort at WLL daN	Weight kg
STW-V 15	*347327	1500	725	350	28	17
STW-V 30	*347365	3000	725	350	28	23
STW-V 50	*347389	5000	725	300	28	29
STW-V 100	*347426	10000	792	300	40	46

¹ Height of lift = Height + Lift

Technical data model STW-V Raku

Model	EAN-No. 4025092* Raku	Capacity kg	Height A mm	Height of lift ¹ mm	Hand effort at WLL daN	Weight kg
STW-V 15	*347402	1500	725	350	28	17
STW-V 30	*347440	3000	725	350	28	23
STW-V 50	*347549	5000	725	300	28	29
STW-V 100	*347570	10000	792	300	40	46

¹ Height of lift = Height + Lift

Technical data model STW-V Sifeku

Model	EAN-No. 4025092* Sifeku	Capacity kg	Height A mm	Height of lift ¹ mm	Hand effort at WLL daN	Weight kg
STW-V 15	*347624	1500	725	350	28	17
STW-V 30	*347631	3000	725	350	28	23
STW-V 50	*347693	5000	725	300	28	29

¹ Height of lift = Height + Lift